

ACCESSORIES



OHF- 800



Air Breathers

CBA-CBB

SERIES CBA

HAND MOUNTING

Air breathers with threaded connection, zinc plated body and chrome plated cap.

Air filter element (not replaceable):
cellulose 3µm
polyurathan 10µm

SERIES CBB

REPLACEABLE ELEMENT

Air breathers with threaded connection by zinc plated steel.

Replaceable filter element, by cellulose 10µm.

SERIES CBA - HAND MOUNTING

SERIES CBB - REPLACEABLE ELEMENT

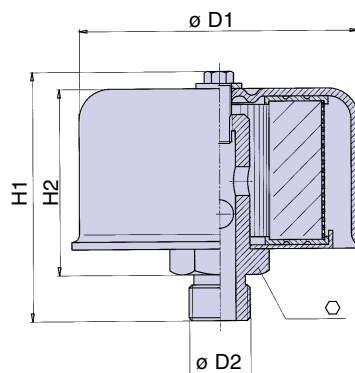
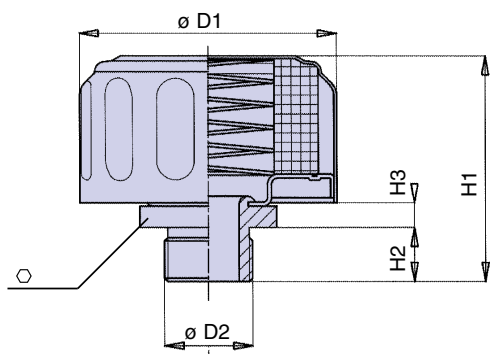

DIMENSIONS

ACCESSORIES

	Filtr. µm	Flow rate (l/min)	D1	D2	○	H1	H2	H3	kg	Spare element
CBA11B02CC	3	150	47	1/4" BSP	19	45	12	7	-	-
CBA11B02PE	10	300	47	1/4" BSP	19	45	12	7	-	-
CBA21B06CC	3	450	76	3/4" BSP	35	66	16	7	-	-
CBA21B06PE	10	750	76	3/4" BSP	35	66	16	7	-	-
CBB11M12CD	10	200	60	M12 x 1,5	17	56	43	-	0,16	EBB11CD
CBB11B03CD	10	200	60	3/8" BSP	22	56	43	-	0,16	EBB11CD
CBB11B02CD	10	200	60	1/4" BSP	22	56	43	-	0,16	EBB11CD
CBB21M16CD	10	500	82	M16 x 1,5	22	71	53	-	0,30	EBB21CD
CBB21B04CD	10	500	82	1/2" BSP	24	71	53	-	0,30	EBB21CD
CBB21B06CD	10	500	82	3/4" BSP	32	71	53	-	0,30	EBB21CD
CBB31B08CD	10	500	115	1" BSP	40	100	76	-	0,30	EBB31CD

Technical data subject to variations without prior notice. CBA-CBB - EN - 10/2009

AIR BREATHER FILTER

CBC

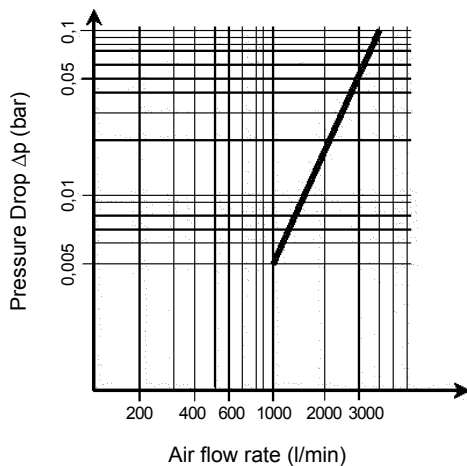
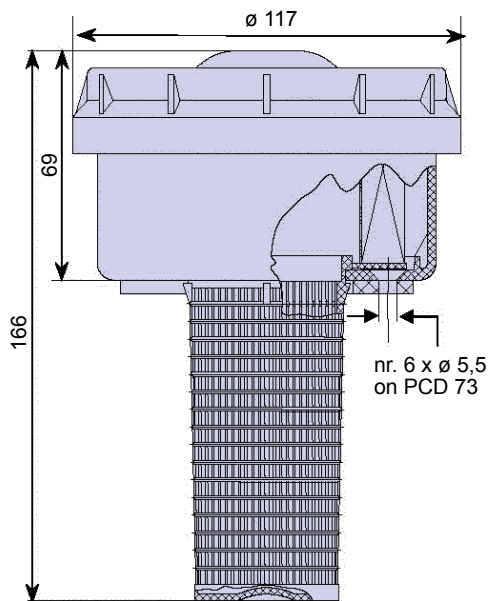

TYPE CBC21SWNCCW

MATERIALS

Housing:
Plastic

Basket:
Plastic

Seals:
Nitrile NBR

SPARE FILTER ELEMENT

Type EBC21NCC:
Cellulose

Filtration degree (in air): $3\mu\text{m}$

COMPATIBILITY

Full with fluids HH - HL - HM - HR - HV - HG (according to ISO 6743/4). For fluids different than the above mentioned, please contact our Sales Department.

WORKING TEMPERATURE

From -25°C to 110°C

Tank Connectors for Air Breathers with Spin-on Cartridge

CBS



Dwg. A
Welding connector

Dwg. B
Flanged connector

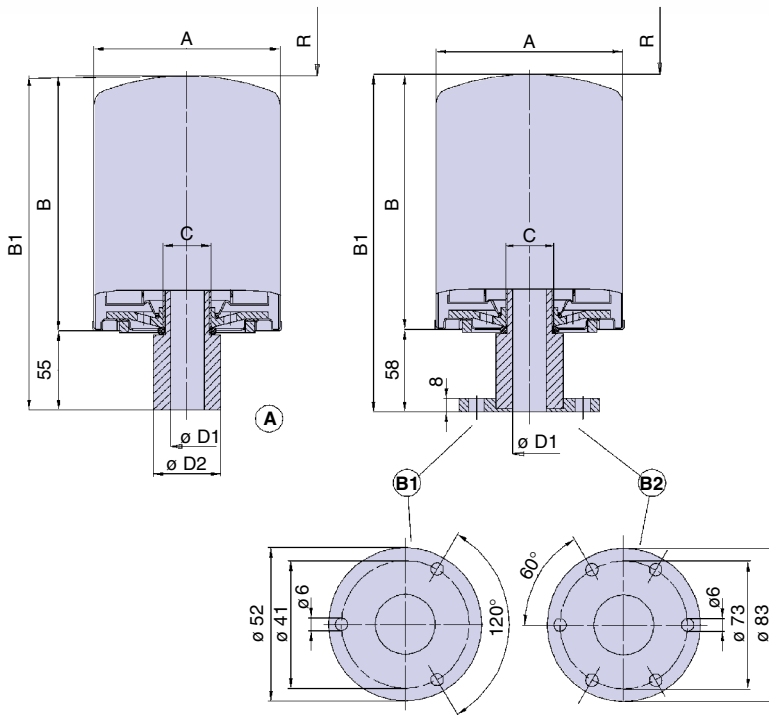

MATERIALS

Connector:
Steel (zinc plated for the flanged version)

Cartridge can:
Steel

Filter media:
CC = Cellulose
FD = Inorganic fiber

Filtration degree (in air): 3µm

COMPATIBILITY

Full with fluids HH - HL - HM - HR - HV - HG (according to ISO 6743/4). For fluids different than the above mentioned, please contact our Sales Department.

WORKING TEMPERATURE

From -25°C to 110°C

DIMENSIONS

ACCESSORIES

Cellulose = CC Inorganic fiber = FD		Dwg.	Flow rate (l/min)	A	B	B1	C	D1	D2	R	Spare cartridge
CBS11WWX	□□	A	1.800	96	146	201	3/4" BSP	18	32	40	ASE11N□□
CBS12WWX	□□	A	1.800	96	191	246	3/4" BSP	18	32	40	ASE12N□□
CBS21WWX	□□	A	2.800	129	181	236	1 1/4" BSP	32	48	40	ASE21N□□
CBS22WWX	□□	A	2.800	129	226	281	1 1/4" BSP	32	48	40	ASE22N□□
CBS11SWC	□□	B1	1.800	96	146	204	3/4" BSP	18	-	40	ASE11N□□
CBS12SWC	□□	B1	1.800	96	191	249	3/4" BSP	18	-	40	ASE12N□□
CBS21SWC	□□	B2	2.800	129	181	239	1 1/4" BSP	32	-	40	ASE21N□□
CBS22SWC	□□	B2	2.800	129	226	284	1 1/4" BSP	32	-	40	ASE22N□□

Air Breathers with Spin-on Cartridge

CSE

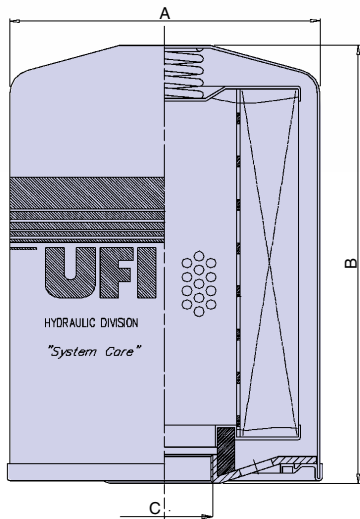

MATERIALS

Adaptor: zinc plated steel

Basket: zinc plated steel

Cartridge can: steel

Filter media:

CC = Cellulose

FD = Inorganic fiber

Filtration degree (in air): 3µm

COMPATIBILITY

Full with fluids HH - HL - HM - HR - HV - HG (according to ISO 6743/4). For fluids different than the above mentioned, please contact our Sales Department.

WORKING TEMPERATURE

From -25°C to 110°C

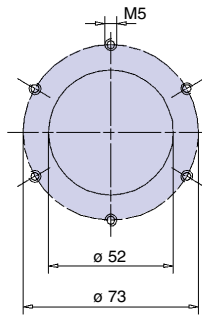
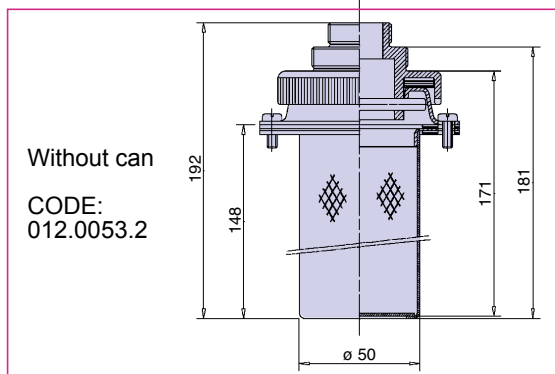

tank connection:
DIN 24557/2

DIMENSIONS

ACCESSORIES

Cellulose = CC Inorganic fiber = FD		Flow rate (l/min)	A	B	C	Spare cartridge
CSE11SWC	<input type="checkbox"/> <input type="checkbox"/>	1.800	95	145	3/4" BSP	ASE11N <input type="checkbox"/> <input type="checkbox"/>
CSE21SWC	<input type="checkbox"/> <input type="checkbox"/>	2.800	129	181	1 1/4" BSP	ASE21N <input type="checkbox"/> <input type="checkbox"/>



Air Dryer Filter Breathers

AIR SENTRY

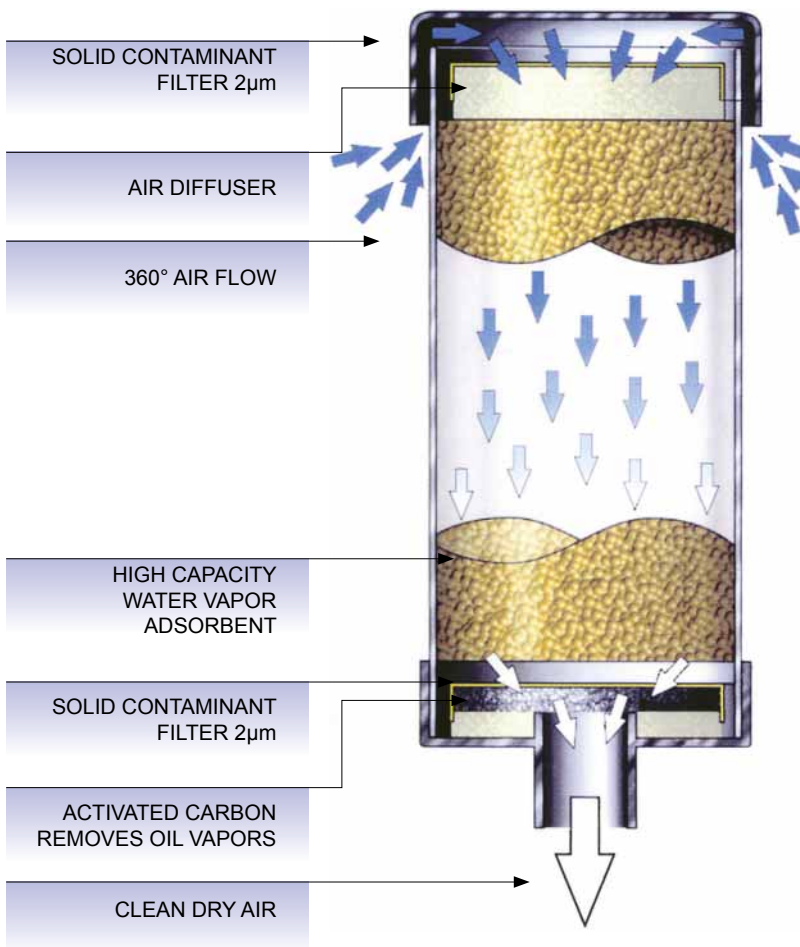

Air Sentry Breathers use a three-stage filtration design to ensure optimum protection by removing **water vapor** and solid contaminants before they enter the fluid system.

First, air passes through a fine, 2µm solid particle filter. The air then passes through a diffuser to ensure maximum effectiveness within the silica gel chamber.

Next, water vapor is removed as the air travels through a bed of silica gel, the highest capacity adsorbent available. After being dried, the air passes through a second 2µm solid particle filter and enter the reservoir, **clean and dry**.

Air entering is cleaned and dried. Expelled air partially regenerates the silica gel and backflushes the particulate filter to prolong the life of the breather.

Silica gel is chemically inert, non-toxic, non-deliquescent and non-corrosive. The internal structure is composed of interconnected microscopic pores that adsorb up to 40% of its weight.

When maximum adsorption is reached, the silica gel turns from yellow to blue to indicate that replacement of the breather is required.

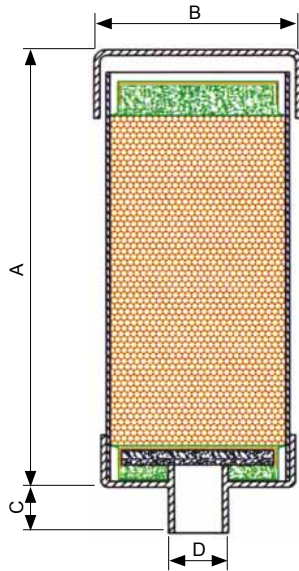

TECHNICAL DATA

Nominal air flow rate: 1.000 l/min

Solid contaminant filtration: 2µm

Silica gel adsorption:
up to 40% of its weight in water

MATERIALS

D-10+ are manufactured from rugged ABS plastic and impact-modified Plexiglas.

R-10+ have a rugged steel reinforced base for heavy duty applications.

WORKING TEMPERATURE

From -30° to +100° C

CONNECTION TO THE RESERVOIR

The breathers D10+ can be attached to the reservoir by using an adapter :

- mod. A-102 for mounting in a threaded hole 1"
- mod. A-104 for bayonet mounting on a standard flange pattern (6 holes on 73 mm PCD)

The breathers R10+ are attached to the re-servoir by 1" NPT male pipe thread.

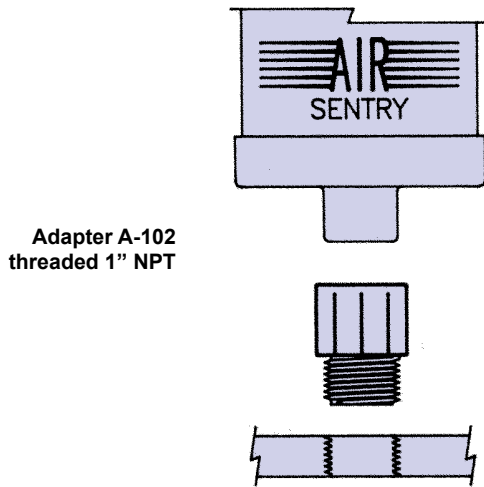

Adapter A-102
threaded 1" NPT

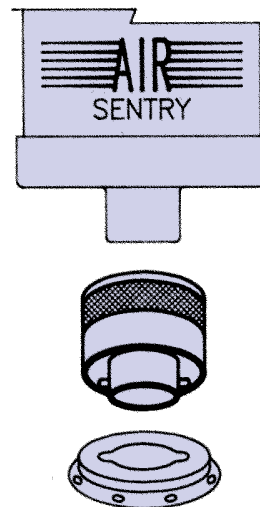

Adapter A-104
bayonet for
standard flange

DIMENSIONS AND WEIGHTS

ACCESSORIES

	A	ø B	C	D	kg	Max H ₂ O capacity (l)
D-101	127	127	32	to fit an adaptor A-10+	1,0	0,2
D-102	205	127	32		1,7	0,5
R-101	140	132	25	1" NPT	1,5	0,2
R-102	216	132	25	1" NPT	2,1	0,5

Visual Level Indicators

CLA

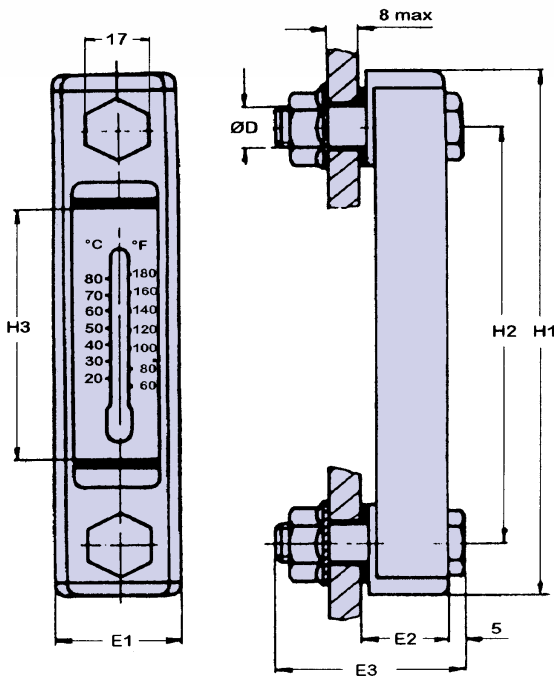

MATERIALS

Visual level indicators, tank side mounting.

Transparent part:
Trogamid T

Anti-shock protection:
painted steel

Fixing bolts:
zinc plated steel

Seals:
Nitrile (Fluoroelastomer available on request).

Double scale thermometer
(Celsius and Farenheit) option available.

Tightening torque for the fixing bolts 10 Nm.

PRESSURE

Max pressure allowed 100 kPa (1 bar).

WORKING TEMPERATURE

From -20° to +90° C

DIMENSIONS

W= without thermometer T= with thermometer

ACCESSORIES

	H1	H2	H3	D	E1	E2	E3
CLA11M10NW	108	76	32	M10	35	24	50
CLA11M10NT	108	76	32	M10	35	24	50
CLA12M12NW	160	127	78	M12	35	24	50
CLA12M12NT	160	127	78	M12	35	24	50
CLA13M12NW	286	254	202	M12	35	24	50
CLA13M12NT	286	254	202	M12	35	24	50